

General Precautions

All trees which are being retained onsite will be protected by protective fencing and/or ground protection as detailed in the following sections. Protective fencing will be erected before any materials or machinery is brought onto the site and before any demolition, development or stripping of soil commences. Once erected fencing will be regarded as sacrosanct and will not be removed or altered without prior recommendation by the project arboriculturist and approval of the Local Planning Authority.

Care will be taken to avoid damage in the following ways:

- Oil, bitumen, cement or other material likely to be injurious to a tree will not be stored or mixed within 10m of any trunk unless contained within a bunded structure.
- Concrete mixing will not be carried out within 10m of a tree unless undertaken within a bunded container. Any spillage shall be immediately reported to the project arboriculturist who will determine what mitigation is required.
- Fires will not be lit nearer than 5m to the limit of the crown spread, will be down-wind of the tree and will be prevented from becoming so large as to affect the tree.
- Notice boards, telephone cables or other services will not be attached to any part of the tree. Trees to be retained will not be used as anchors for equipment used to remove stumps, roots, other trees or for any other purposes.
- Care will be exercised when using cranes or similar equipment near the spread of the canopy of a tree.
- It is essential that allowance be made for the slope of the ground so that damaging materials such as concrete washings, mortar or diesel oil cannot run towards trees.
- Stumps within the RPA will not be dug or pulled out but are to be ground out. Where possible, and with the agreement of all parties involved, standing stumps and debris should be left as a habitat for wildlife if circumstances allow. (British Standards Institute, 2012) (National House Building Council, 2010) (Anon., 1981).

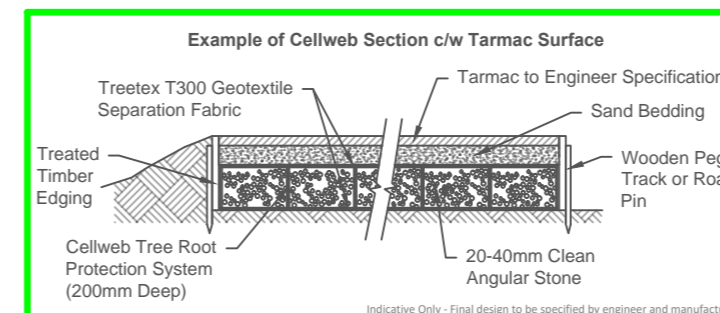
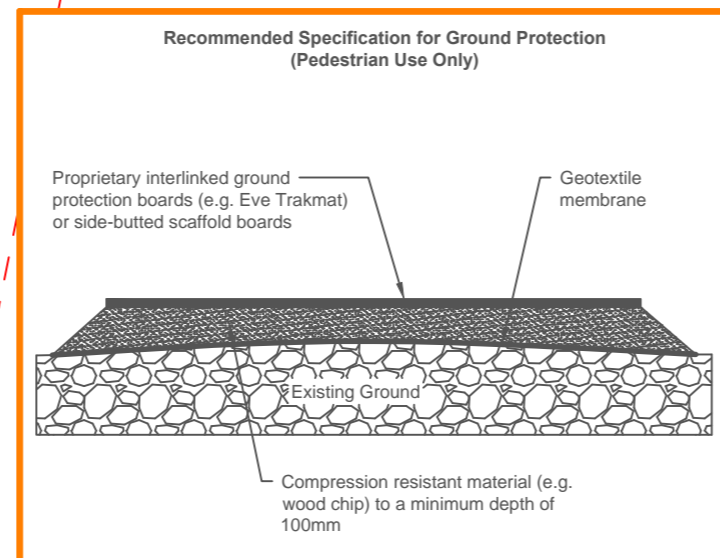
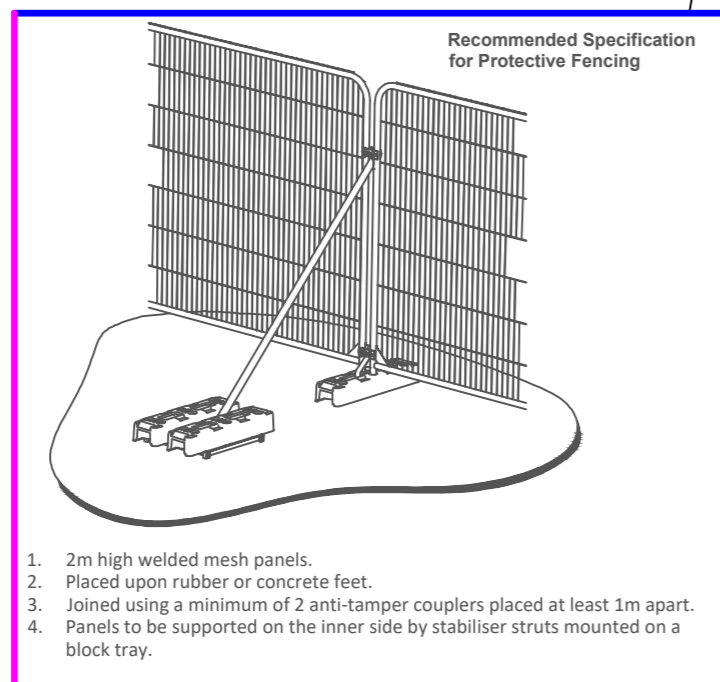
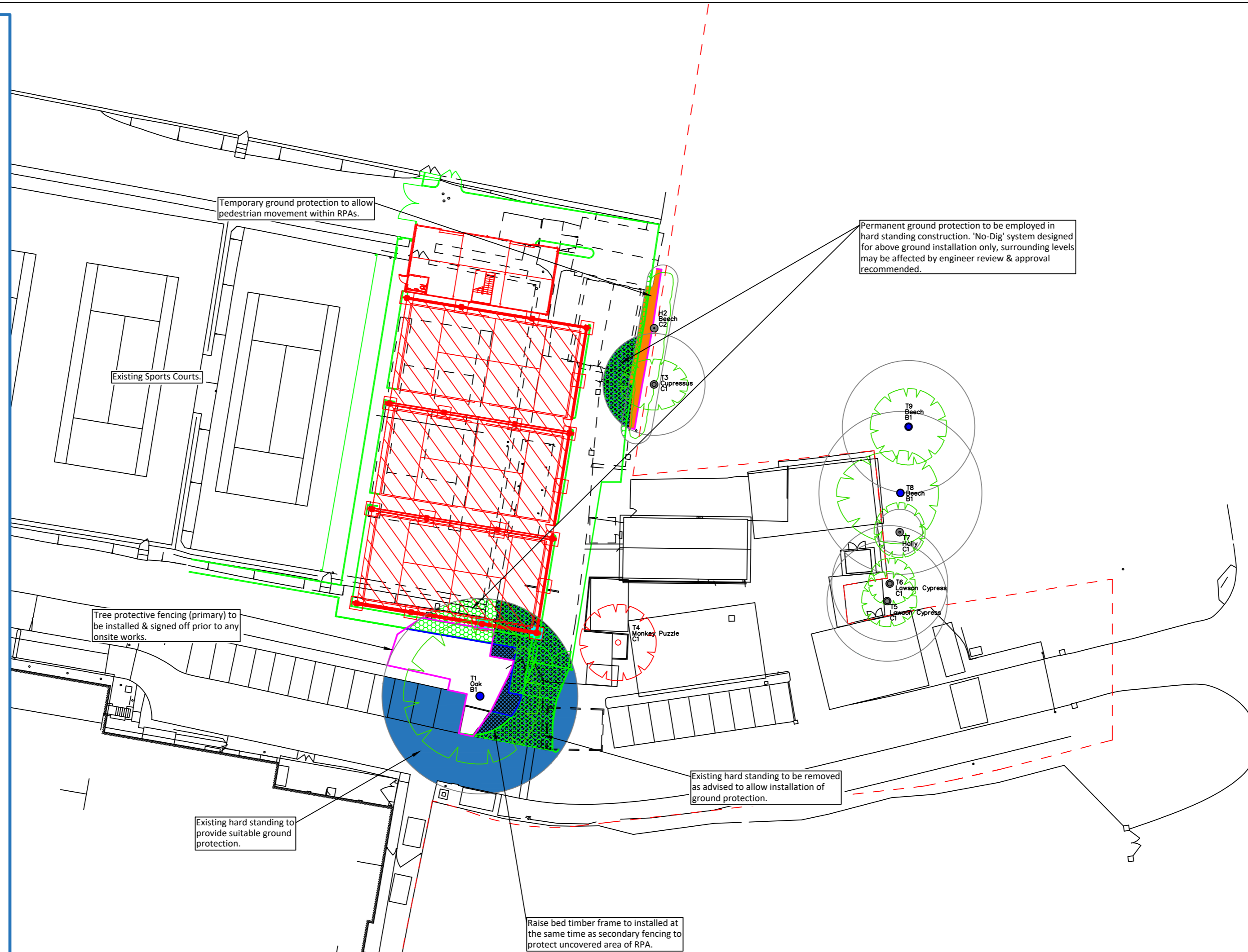

KEY

- CATEGORY 'A' TREE
- CATEGORY 'B' TREE
- CATEGORY 'C' TREE
- CATEGORY 'D' TREE
- ROOT PROTECTION AREAS
- RETAINED PROTECTED TREES
- RETAINED PROTECTED HEDGES
- PROPOSED TREE REINSTALLS
- BASE PLANT/TOPOGRAPHICAL SURVEY DETAIL
- - - INDICATIVE SITE BOUNDARY
- - - EXISTING BUILDINGS/HARD FEATURES TO BE RETAINED
- - - EXISTING BUILDINGS/HARD FEATURES TO BE DEMOLISHED
- - - PROPOSED BUILDINGS/STRUCTURES
- - - PROPOSED HARD FEATURES/ROADS
- - - TREE PROTECTION FENCING PRIMARY
- - - TREE PROTECTION FENCING SECONDARY
- - - EXISTING GROUND PROTECTION
- - - TEMPORARY GROUND PROTECTION
- - - PERMANENT GROUND PROTECTION
- - - AREA OF SUPERSEDED HARD STANDING REMOVAL
- - - AREA OF SUPERSEDED EXCAVATION

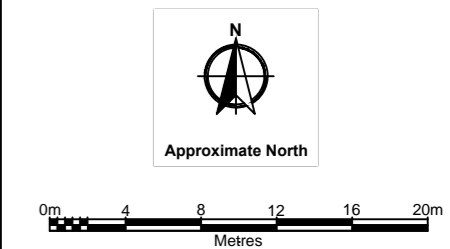

Notes:

- Drawing is based upon Existing Site Plan.dwg
- Proposed drawing details taken from Proposed Site Plan.dwg
- This drawing must be read in conjunction with Arboricultural Report Ref. 23 2308

PRINT IN COLOUR ON A2 PAPER
All measurements in millimeters
© Arb Consultancy Limited
Do not reproduce without prior consent

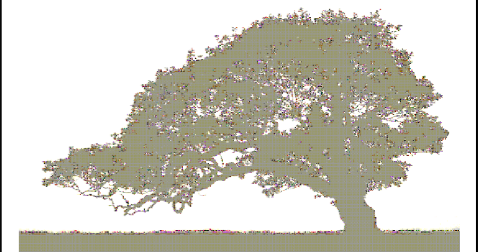

Arb Consultancy Limited

85 South Terrace T 01306 500382
Dorking M 07971 121948
Surrey E info@arbconsultancy.co.uk
RH4 2AF

Client
St. George's Hill Lawn Tennis Club

Site
St. George's Hill Lawn Tennis Club, St. George's Hill, Weybridge, KT13 0LL

Drawing Title
Tree Protection Plan

Rev. Details Date
1. Revised to include red line site boundary. 10/03/2023

PRINT IN COLOUR ON A2 PAPER

Project No 23 2308 Surveyed by KM

Drawn by JB/KM Checked by KM/JP

Date 10/03/2023 Scale 1:400@A2

Drawing Number 23 2308 TPP 001 Rev 1