

Title	Tree Protection Plan	Root Protection Area	Ground Protection	No dig surfacing	Sensitive excavations	Construction Exclusion Zone
Drawing no.	RMT694 - TPP - Rev D	Canopy Spreads	Ground Protection	No dig surfacing	Sensitive excavations	CEZ
Scale	1:200 @ A1	Pruning indication	Ground Protection	No dig surfacing	Sensitive excavations	CEZ
Date	July 2024	Tree Protection Fencing	Ground Protection	No dig surfacing	Sensitive excavations	CEZ

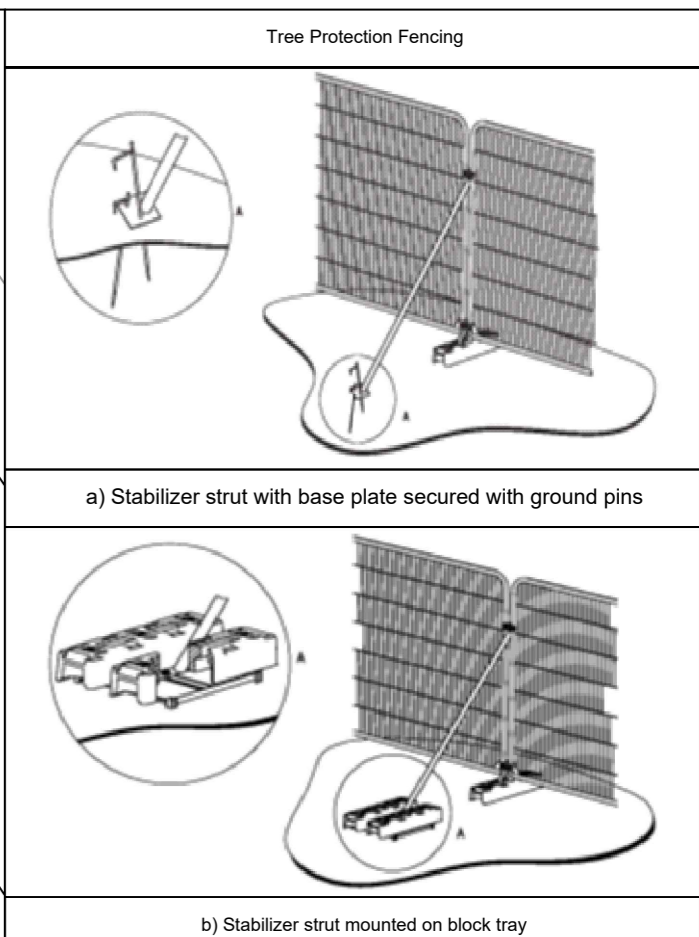
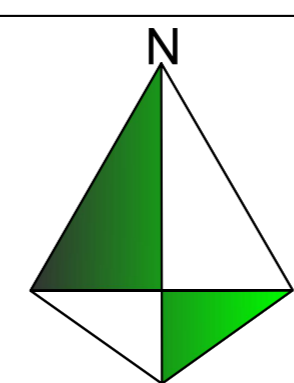

Images taken from British Standard BS27:2012 - Trees in relation to design, demolition and construction - Recommendations

TREE PROTECTION AREA

THEES ENCLOSED BY THIS FENCE ARE PROTECTED BY FAVORABLE CONDITIONS AND ARE SUBJECTS OF A TREE PRESERVATION ORDER (TPO) & COUNTY PLANNING ACT 1990.

CONTRAVENTION OF TREE PRESERVATION ORDERS MAY LEAD TO CRIMINAL PROSECUTION.

THE FOLLOWING MUST BE OBSERVED BY ALL PERSONS -

- THE PROTECTIVE FENCING MUST NOT BE REMOVED
- NO PERSON SHALL ENTER THE PROTECTED AREA
- NO MACHINE OR PLANT SHALL ENTER THE PROTECTED AREA
- NO MATERIALS SHALL BE STORED IN THE PROTECTED AREA
- NO SPILL SHALL BE DEPOSITED IN THE PROTECTED AREA
- NO EXCAVATION SHALL OCCUR IN THE PROTECTED AREA

ANY INCURSION INTO THE PROTECTED AREA MUST BE WITH THE WRITTEN PERMISSION OF THE LOCAL PLANNING AUTHORITY

KEEP OUT!

- Root Protection Area and Construction Exclusion Zones
- All tree protection measures will be erected as agreed within the BS5537:2012 Arboricultural Survey, Implications Assessment and Arboricultural Method Statement;
 - There will be access to foot or vehicular traffic within fenced off areas once development (including demolition) has commenced;
 - Once development (including demolition) has commenced the tree protection must not be moved for any reason without the written consent of the local planning authority;
 - There will be no excavations, storage of materials, mixing of materials or dumping of spoil within construction exclusion zones (CEZ) unless agreed in writing with the local planning authority;
 - All caustic substances e.g. oil, diesel, cement etc will not be stored within 2m of CEZs;
 - No trees will be lit within 10m of CEZs or tree canopies;
 - Protection area signage will be displayed on protective barriers for the duration of development;
- PLEASE BE AWARE - The tree protection specified on this tree protection plan and within the Arboricultural Survey, Implications Assessment and Arboricultural Method Statement document are considered to be essential. Failure to protect trees in full accordance with the approved scheme is likely to result in local planning authority taking enforcement action, including prosecution.
- Specification for scaffold ground protection.

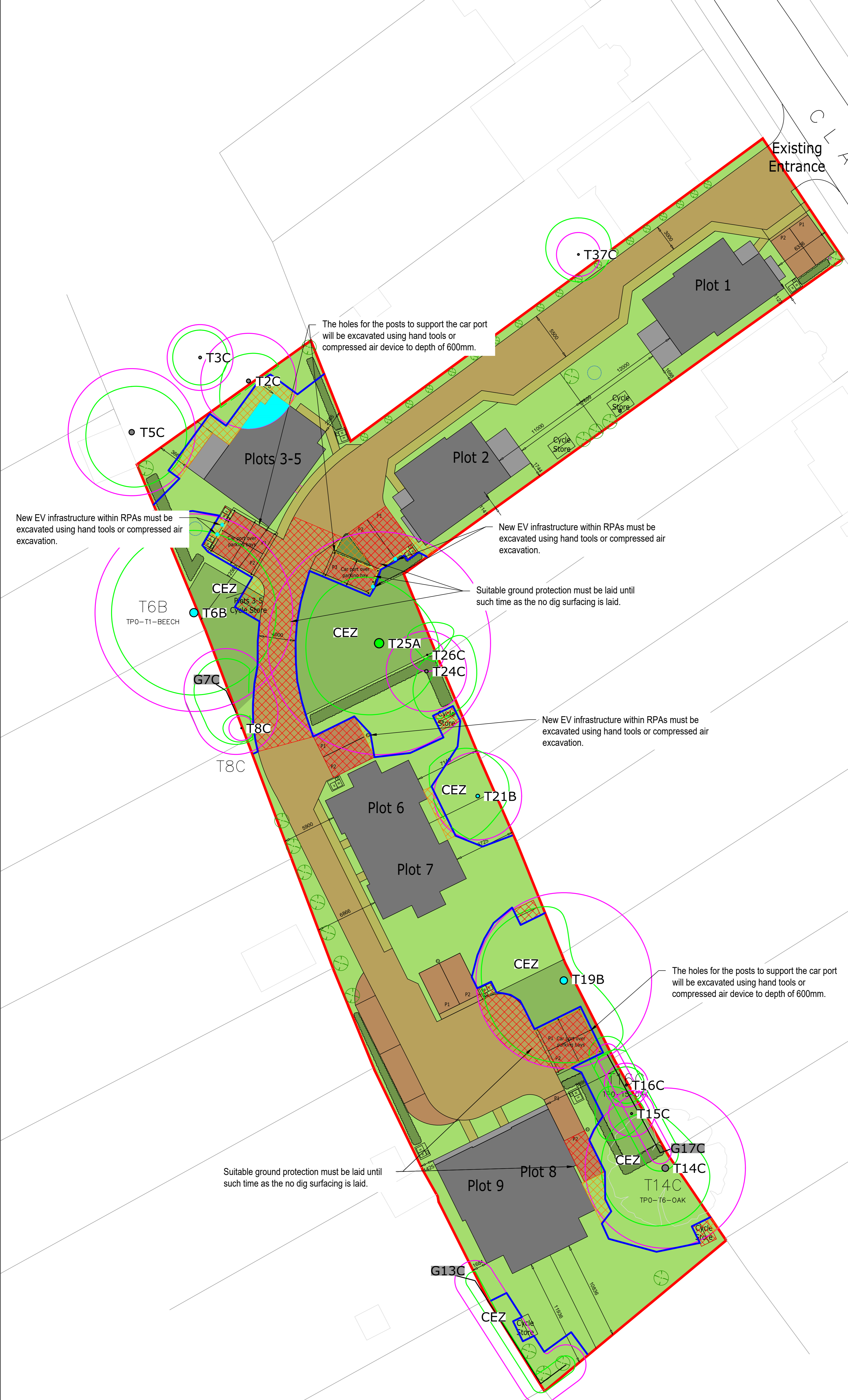
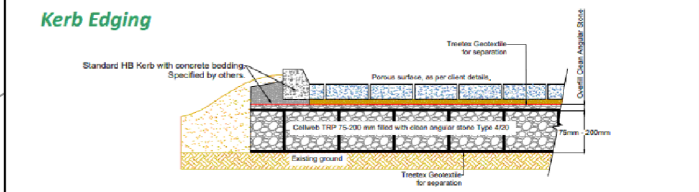
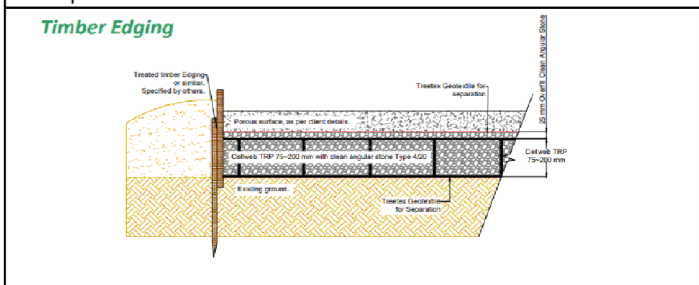
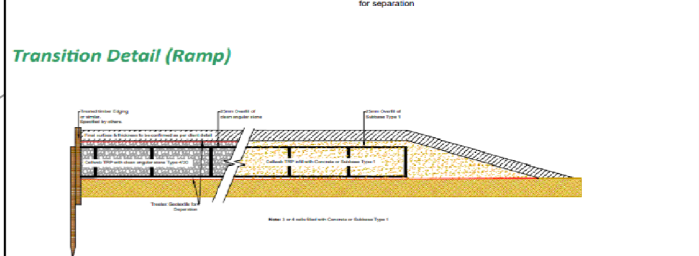
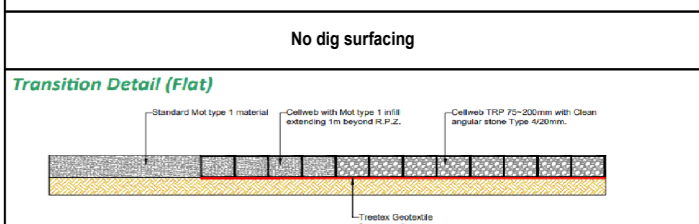
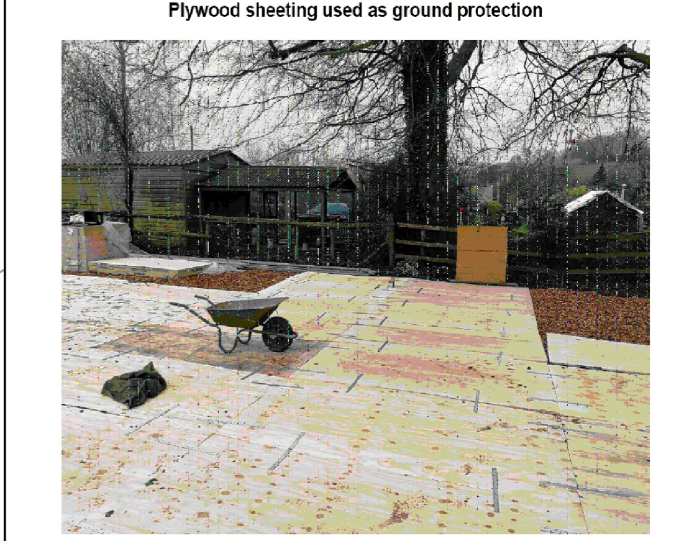
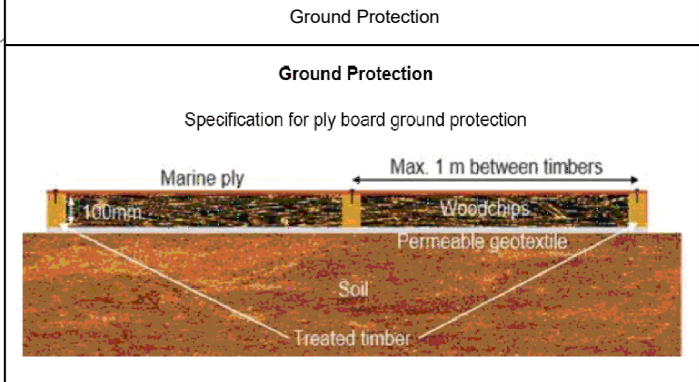

Transition Detail (Flat)

Transition Detail (Ramp)

Timber Edging

Kerb Edging